

MM7101##E
MM7102##E
MM7103##E

MM7104##E
MM7105##E
MM7106##E



ALL ILLUSTRATIONS OF THE PRODUCT ARE FOR REFERENCE ONLY. COMPONENTS SUPPLIED WITH INDIVIDUAL PRODUCTS MAY DIFFER

ALL PRODUCT DIMENSIONS DETAILED IN THIS INSTALLATION AND MAINTENANCE MANUAL ARE APPROXIMATE

CONTACT DETAILS (UK)

Croydex
Central Way
Andover
Hampshire
SP10 5AW
UK

Tel: +44 (0)1264 365881
Email: info@croydex.co.uk
Web: www.croydex.com

CONTACT DETAILS (EU)

MIL
Unit 8 Purcellsinch Ind Est
Dublin Road
Kilkenny
R95 HP71
Ireland



ALWAYS CHECK THE PACKAGING FOR FIXINGS AND PARTS BEFORE RECYCLING OR DISPOSAL.

PLEASE READ THROUGH AND FULLY UNDERSTAND THE INSTRUCTION LEAFLET BEFORE STARTING THE INSTALLATION OF THIS MIRROR.

ENSURE YOU HAVE ALL THE FIXINGS AND PARTS BEFORE ATTEMPTING TO ASSEMBLE OR FIT THIS PRODUCT.

SECTION 1 - INTRODUCTION

Thank you for purchasing this Croydex product. Please follow the fixing and care instructions to ensure that your product is fitted safely and that it retains its high quality finish. **PLEASE RETAIN THIS MANUAL FOR FUTURE REFERENCE.**

IMPORTANT WARRANTY INFORMATION

In some circumstances the Building Regulations 2010 require the installer to give the occupier of the premises in which this product has been installed a certificate to confirm that the requirements of regulations 4 and 7 have been satisfied, or the installation of this product must be inspected and tested by the Local Authority Building Control Department who will issue a compliance certificate.

A copy of this certificate may be required for certain warranty claims. Failure to provide a copy of the certificate may invalidate the warranty. This does not affect your statutory rights. We recommend that you make yourself aware of the Regulations before you undertake any work and if you require clarification you should contact your Local Authority Building Control Department.

MM7101##E - Input: 220 - 240V ~ AC 17W Rating: IP44
MM7102##E - Input: 220 - 240V ~ AC 26W Rating: IP44
MM7103##E - Input: 220 - 240V ~ AC 26W Rating: IP44
MM7104##E - Input: 220 - 240V ~ AC 17W Rating: IP44
MM7105##E - Input: 220 - 240V ~ AC 42W Rating: IP44
MM7106##E - Input: 220 - 240V ~ AC 27W Rating: IP44

SAFETY & PRODUCT CARE

1. It is recommended that two people fit the mirror to ensure that it is fitted safely.
2. **ALWAYS** take care when using power tools, particularly if there is any water in the working area.
3. **ALWAYS** wear eye protection when using power tools.
4. **ALWAYS** check for pipes and cables before drilling into walls.
5. **ALWAYS** use a Residual Current Circuit Breaker (RCCB).
6. **ALWAYS** use a ceramic drill bit when drilling into tiled surfaces.
7. **ALWAYS** use a drill bit that is suitable for the surface that is being drilled.
8. The wall plugs supplied are for use on solid walls only. For cavity walls or plasterboard **ALWAYS** use specialist fixings that are suitable for the type of wall construction.
9. **DO NOT** use abrasive or chemical cleaners as these may damage the product.
10. **DO NOT** strike the mirror with hard or sharp objects.
11. **DO NOT** drill on the grout line of tiles.
12. **ALWAYS** use masking tape on tiles surfaces.
13. **DO NOT** position glass components in close contact with a heat source.

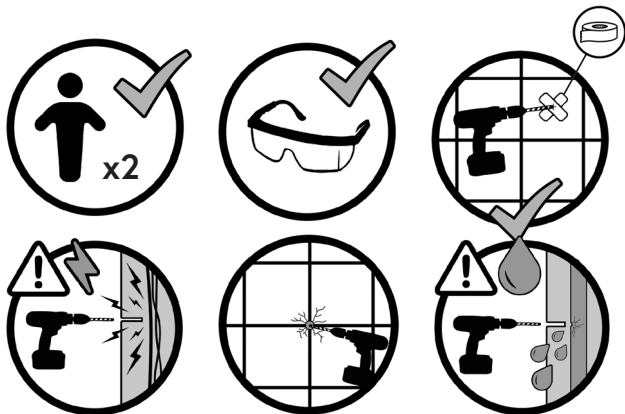

IMPORTANT INSTALLATION INFORMATION

This is a class 1 appliance and **MUST NOT** be connected to earth.

Hazardous voltages inside - **DO NOT** remove any covers.

This product **MUST ONLY** be installed in accordance with the installation instructions.

Connection of the electrical supply **MUST ONLY** be carried out by a competent person.

Keep DIY tools out of the reach of children.

Installation **MUST** be carried out by a competent electrician in accordance with the Building Regulations 2010 and connection to the fixed wiring of the mains electrical supply must comply with the current revision of the IET Wiring Regulations BS 7671.

TOOLS REQUIRED

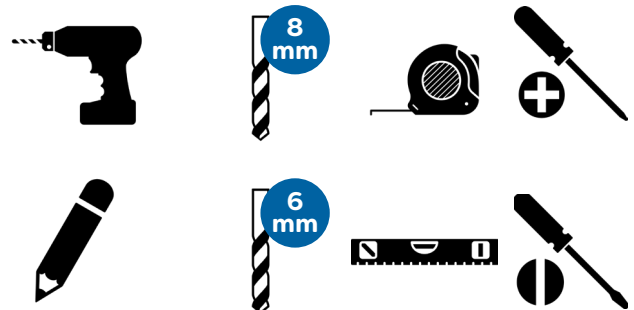

WALL FIXING PACK

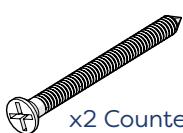

x2 Countersink Screw

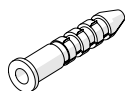

x4 Hang 'n' Lock Wall Plug

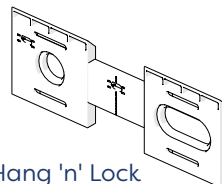

x1 Hang 'n' Lock Bracket



x2 Cam

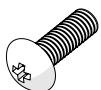

x1 Button Head Screw

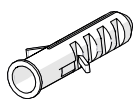

x1 L-Bracket Wall Plug

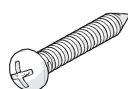

x2 Roundhead Screws



x2 Sticky Pads

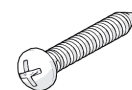

x1 L-Shaped Bracket Screw

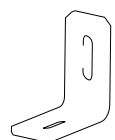

x1 L-Shaped Bracket

POSITIONING THE MIRROR

1. The mirror is rated IP44 and must only be installed with the connection to the domestic mains electrical supply in the Outside Zones, as shown in **Fig. 1**.
2. Ensure that the access to the domestic mains electrical supply is located behind the intended mounting position for the mirror and unobstructed by the mounting brackets.

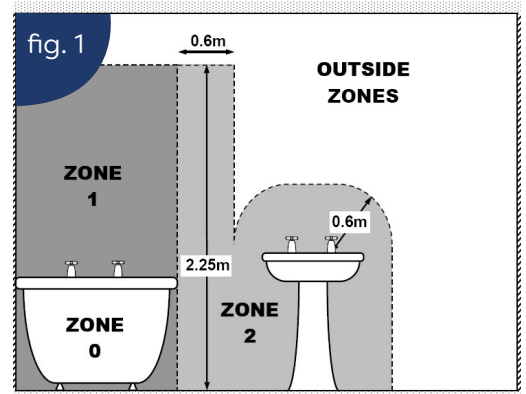

SECTION 2 - MOUNTING USING HANG 'N' LOCK

1. Assemble the Hang 'n' Lock bracket sections making sure all parts are slotted tightly together.

(See Fig. 2)

Note: The Hang 'n' Lock bracket may vary in size.

fig. 2

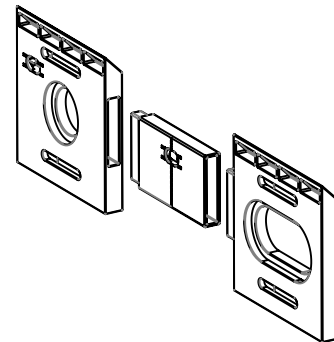

2. Place the assembled Hang 'n' Lock bracket onto the support slot on the back of the mirror and hold in place. Measure the distance from the bottom bracket to the top edge of the mirror glass. Make a note of the 'Bracket Distance' as it will help you when mounting your mirror.

(See Fig. 3)

fig. 3

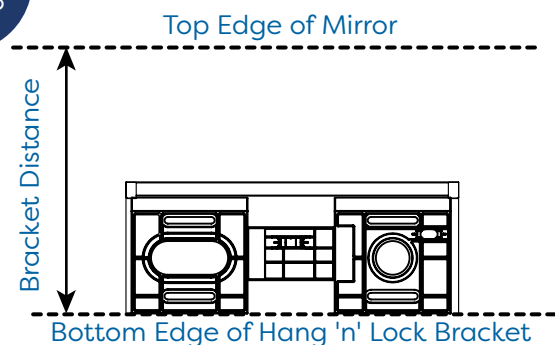

3. Carefully hold your mirror in the desired location on the wall and using a pencil make a reference line along the top edge of the mirror. Use the Bracket Distance you measured earlier to create a reference line where the bottom of your Hang 'n' Lock bracket will be located.

(See Fig. 4)

fig. 4

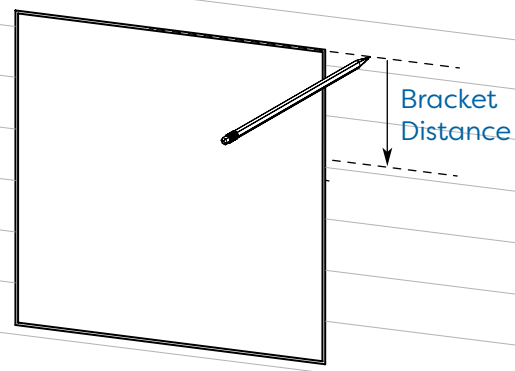

4. Place the bottom edge of the Hang 'n' Lock bracket onto the lower reference line and mark a screw hole position in each cam hole recess. Remove the bracket from the wall.

(See Fig. 5)

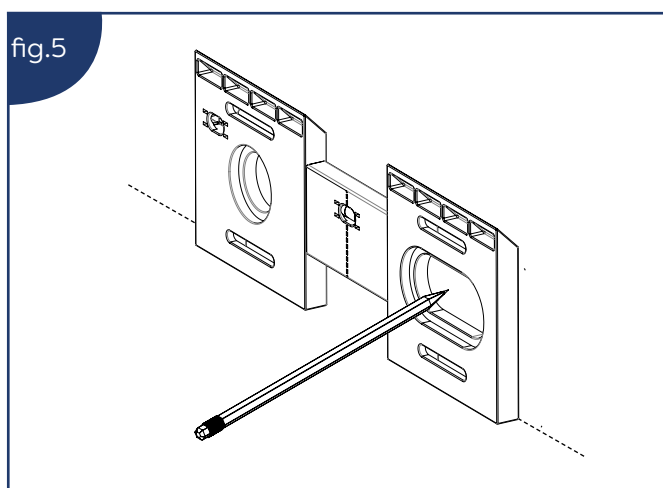

5. Drill holes to a depth of 45mm and insert the wall plugs level with the surface of the wall. Insert the countersink screws through the Hang 'n' Lock cams and loosely secure the Hang 'n' Lock bracket to the wall.

The wall plugs supplied are for use on solid walls only. For cavity walls or plasterboard use specialist fixings that are available from all good DIY stores. (See Fig. 6)

Note: if you are fitting the product to a tiled surface, insert the wall plugs below the surface of the tile to avoid cracking the tiles.

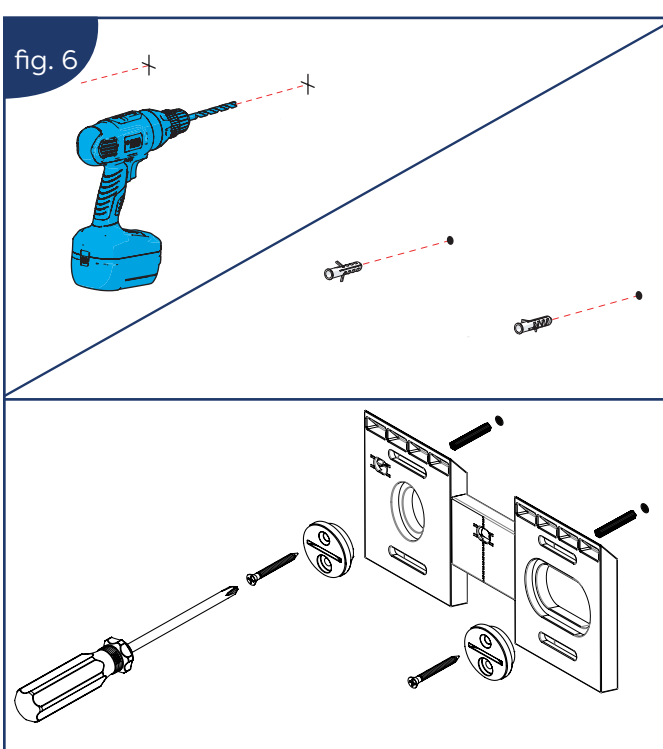

6. With the Hang 'n' Lock bracket loosely attached to the wall, adjust for height and level by rotating the cams with a flat head screwdriver. Use the attached spirit level as a guide. Once complete, fully tighten the mounting screws to securely fix the bracket into position.

(See Fig. 7)

Note: The position of the mirror can be adjusted by sliding left or right along the bracket.

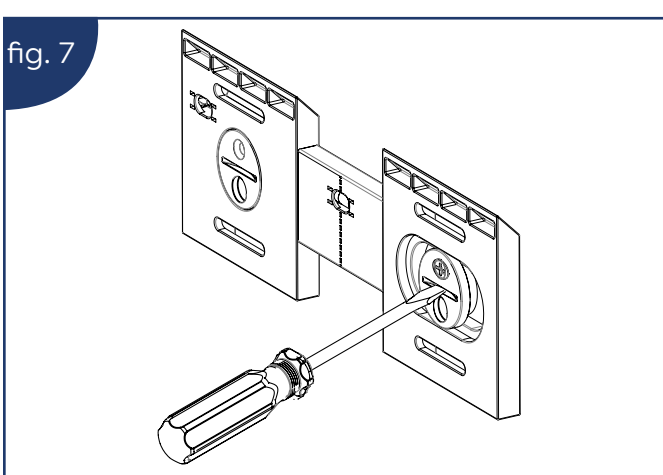
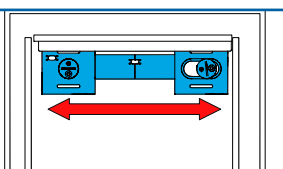

7. Peel one side of the buffer off the backing paper and push onto the back of the mirror frame at the bottom of the mirror. Repeat with the second sticky pad on the right side.

(See Fig. 8)

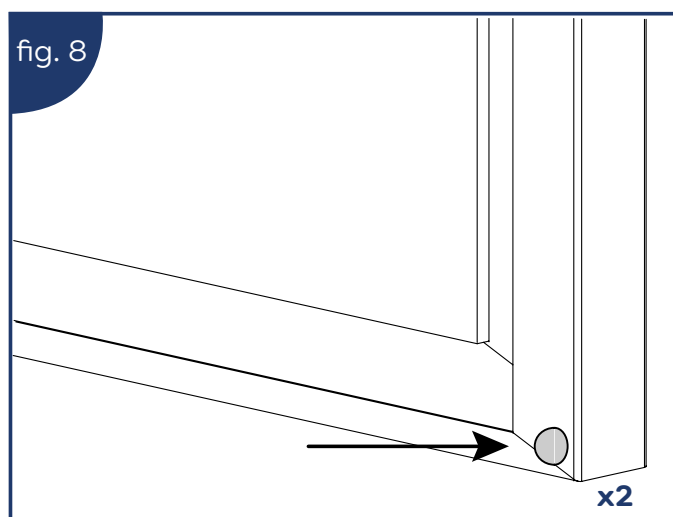

8. With the mirror connected to the electrical supply, hang the mirror onto the Hang 'n' Lock bracket. Ensure the mirror has securely located onto the bracket before letting go.

(See Fig. 9)

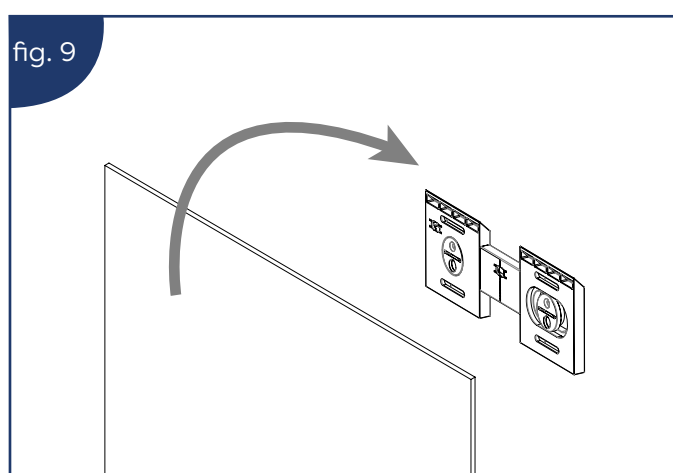

*** Follow Step 9 if you have one of the following products that allow for landscape orientation ***

9. The mirrors that can be mounted in landscape orientation are:

MM710500E - Sherston Illuminated Mirror

MM710600E - Cheaton Illuminated Mirror

To do this, measure the distance between the keyhole slot centres and use a spirit level to mark two points on the wall. Drill the mounting holes in the marked positions using a 6mm drill bit and insert the screws, ensuring that the screw head extends out of the wall by approximately 5mm. Adjust screw depth for a secure fit.

(See Fig. 10)

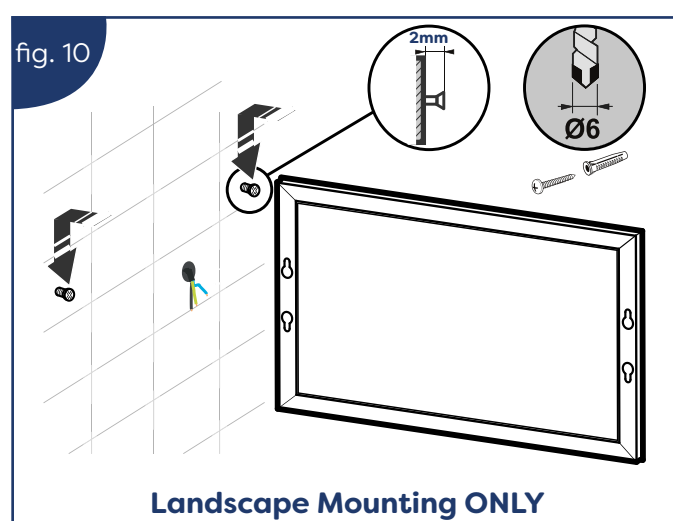

10. Place the L bracket over the threaded hole located at the bottom of the mirror. Using a pencil mark the position of the L bracket onto the wall.

(See Fig. 11)

11. Remove the mirror and place the bracket on the mark and drill a hole in the centre of the slot on the wall. Lightly screw the bracket to the wall, allowing the bracket to be moved up and down the slot.

Remove the mirror to connect the electrical supply.

(See Fig. 11)

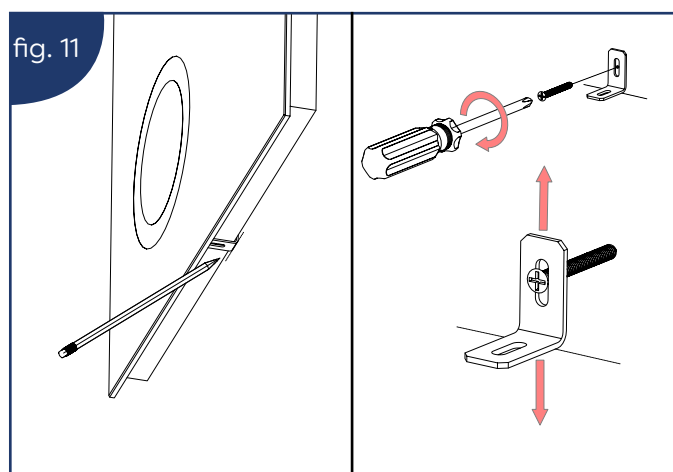

*** Refer to SECTION 5 - CONNECTING THE ELECTRICAL SUPPLY before proceeding to Step 12 and fastening the mirror. ***

12. With the mirror in place and connected to the electrical supply, secure the L bracket to the mirror using the bolt provided.

(See Fig. 12)

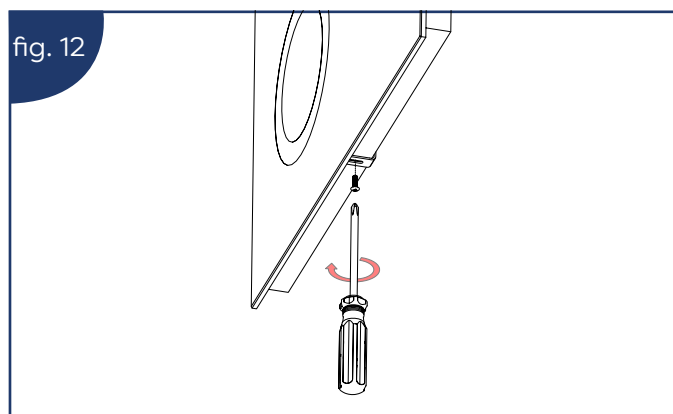

SECTION 4 - OPERATING INSTRUCTIONS

To turn the LED lights on or off, operate the touch switch on the front of the mirror glass.

SECTION 5 - CONNECTING THE ELECTRICAL SUPPLY

ENSURE THAT THE DOMESTIC ELECTRICAL MAINS SUPPLY TO WHICH THE CABINET IS TO BE CONNECTED IS TURNED OFF.

Connect the flexible mains supply cable on the mirror to the domestic electrical mains supply ensuring that:

- The Live (Brown) conductor is connected to the Live on the domestic electrical mains supply.
- The Neutral (Blue) conductor is connected to the Neutral on the domestic electrical mains supply.
- The Earth (Green/Yellow) conductor is connected to the Earth/Ground on the domestic electrical mains supply.

Note: Connection of the product to the domestic electrical mains supply must only be carried out by a Building Regulations Part P certified electrician or must be checked by your Local Authority Building Control Department.

PRODUCT REPAIR

In the unlikely event that your shaver unit or LED lighting becomes faulty, they can be replaced by a qualified electrician. Detailed repair instructions (REPO0002.pdf) can be downloaded from www.croydex.com or requested from info@croydex.co.uk.

PRODUCT RECYCLING

This product has been designed so that electrical components can be easily removed by the consumer for recycling at end of life. A detailed Electronic and Electrical Waste Recycling Guide (WEEE00002.pdf) can be downloaded from www.croydex.com or requested from info@croydex.co.uk.



THIS PRODUCT COMPLIES WITH THE REQUIREMENTS OF:

- The UK Electrical Equipment (Safety) Regulations 2016
- The UK Electromagnetic Compatibility Regulations 2016
- The UK Restriction of the Use of Certain Hazardous Substances in Electrical and Electronic Equipment Regulations 2012
- The EU Low Voltage Directive (LVD) 2014/35/EU
- The EU Electromagnetic Compatibility (EMC) Directive 2014/30/EU
- The EU Restriction of Hazardous Substances (RoHS) Directive 2011/65/EU

The following UKCA and CE Declarations of Conformity can be downloaded from www.croydex.com or requested from info@croydex.co.uk:

- UKCA electrical safety and EMC (UKCA-DoC-00009-Safety-EMC.pdf)
- UKCA RoHS (UKCA-DoC-00009-RoHS.pdf)
- EU CE LVD and EMC (CE-DoC-00009-LVD-EMC.pdf)
- EU CE RoHS (CE-DoC-00009-RoHS.pdf)

SECTION 8 - DECLARATION OF CONFORMITY



THIS PRODUCT COMPLIES WITH THE REQUIREMENTS OF

The UK Electrical Equipment (Safety) Regulations 2016

The UK Electromagnetic Compatibility Regulations 2016

The UK Restriction of the Use of Certain Hazardous Substances in Electrical and Electronic Equipment Regulations 2012

The EU Low Voltage Directive (LVD) 2014/35/EU

The EU Electromagnetic Compatibility (EMC) Directive 2014/30/EU

The EU Restriction of Hazardous Substances (RoHS) Directive 2011/65/EU

The following UKCA and CE Declarations of Conformity can be requested from info@croydex.co.uk or downloaded from www.croydex.com:

UKCA electrical safety and EMC (UKCA-DoC-00001-Safety-EMC.pdf)

UKCA RoHS (UKCA-DoC-00001-RoHS.pdf)

EU CE LVD and EMC (CE-DoC-00001-LVD-EMC.pdf)

EU CE RoHS (CE-DoC-00001-RoHS.pdf)